

# J&J West Coast Campus Guide

Fremont CA - CWCC



Welcome to the  
**Johnson & Johnson Diabetes Solutions Companies**  
West Coast Campus.

6500 Paseo Padre Parkway  
Fremont, CA 94555  
(510) 248-2400

*Johnson & Johnson*  
DIABETES SOLUTIONS COMPANIES

# J&J West Coast Campus Guide

Fremont CA - CWCC

CONTENTS (...just click on what you need)



**Welcoming You...**



**Getting Here:** Where's the campus and what are my options for commuting?



**Getting Around:** Now that I'm here, where exactly am I and how do I find things?



**Doing Business:** How do I get set up and find the support I need for my work as well as other services?



**Eating Here and There:** Where can I get a cup of coffee, a meal, or a snack?



**Keeping Fit:** What's available to help me stay on top of my exercise routine?



**Managing Life:** What's available in the surrounding neighborhood to help me handle my personal business?

6500 Paseo Padre Parkway  
Fremont, CA 94555

# Expanded Contents

(...now, please click on what you specifically need)



**Getting Here:** Where's the campus and what are my options for commuting?

- Campus address and phone
- Directions to the facility
- Bridge tolls
- Public transportation
- Carpooling (program and incentives)
- Vanpools
- Biking to campus



**Getting Around:** Now that I'm here, where exactly am I and how do I find things?

- Campus map
- Floor plan for 2nd floor (Bldg. 1): Meeting and service rooms
- Floor plan for 2nd floor (Bldg. 1): Individual office/cubicle assignments
- Floor plan for 1st floor (Bldg. 1): Meeting and service rooms



**Doing Business:** How do I get set up and find the support I need for my work as well as other services?

- Identification badges: Employees, contractors, and visitors
- Keys: Offices, desks, cubicles, and file cabinets
- Calling Fremont Campus phone numbers
- Directory of important services
- Facilities Service Requests
- Office equipment and technical support
- Ergonomics
- Business cards (new or updating)
- Updating your address and contact information in JJEDS
- Office supplies
- Mail, FedEx, and shipping/receiving
- Conference rooms
- Catering for meetings
- Events and All-Hands meetings
- Visitor accommodations/hotels

# Expanded Contents

(...now, please click on what you specifically need)  
... continued



**Eating Here and There:** Where can I get a cup of coffee, a meal, or a snack?

- Break rooms, onsite coffee bars, vending machines
- Nearby restaurants
- Coffee or tea (off-campus)
- On-campus eating areas



**Keeping Fit:** What's available to help me stay on top of my exercise routine?

- Fitness center
- Other on- or near-campus sports and fitness options
- Showers and lockers



**Managing Life:** What's available in the surrounding neighborhood to help me handle my personal business?

- Shopping centers/malls nearby
- Gas stations nearby



# Welcoming You...

## Dear Colleagues:

It's a pleasure to welcome you to Johnson & Johnson's Fremont Campus! This is an exciting time and we are pleased to share this Fremont Campus Guide with you to help make your move and transition to Fremont as smooth as possible.

The guide is full of useful information to help familiarize you with both the new campus and the surrounding Fremont area. We've organized the guide with a table of contents so you can easily find and print the information you'd like to keep handy. Outlined in the guide you'll find answers to commonly asked questions about directions to campus, locations of amenities on campus, your initial set-up, places to eat or exercise, and even nearby shopping options.

As you know, this move is an important part of our long-term strategy to drive growth and competitiveness efficiently while retaining core capabilities and expertise here in California. We are excited about the opportunities the move provides for us, both internally and across our multiple businesses and sectors.

If you have any additional questions after reviewing this guide, please do not hesitate to contact the Facilities Help Desk at ext. **2411** for assistance. We look forward to seeing you around the Fremont campus!

Sincerely,

Your Fremont Move Leadership Team

**Loren Arms Christy Dorris Maricela Monge Bill Brier Stefana Burlacu Adam Laponis**



## Getting Here:

Where's the campus and what are my options for commuting?

- **Campus address and phone**

6500 Paseo Padre Parkway  
Fremont, CA 94555  
Main: (510) 248-2400

- **Directions to the facility (options)**

*From the South Bay/San Jose Airport:*

*Route 1*

- Follow 101 North toward San Francisco
- Take the Willow Road/84 East Exit
- Follow signs for 84 East toward Fremont/Dumbarton Bridge
- Cross the Dumbarton Bridge
- Take the first exit, Paseo Padre Parkway/Thornton Ave.
- Take a left over the freeway onto Paseo Padre Parkway
- Proceed on Paseo Padre Parkway to the last campus entrance on the right, before Commerce Drive

*Route 2*

- Follow 880 North toward Oakland
- Exit at 84 West toward Dumbarton Bridge, turning left on 84 West
- Take the Thornton Ave./Paseo Padre Parkway Exit
- Turn right onto Paseo Padre Parkway
- Proceed on Paseo Padre Parkway to the last campus entrance on the right, before Commerce Drive

*From North Bay/Marin San Francisco Airport/San Francisco:*

- Follow 101 South toward the San Francisco Airport and San Jose
- Take the Marsh Road Exit toward Atherton/Dumbarton Bridge
- Turn left onto Marsh Road/84 East going back over the freeway
- Follow signs for 84 East toward Fremont/Dumbarton Bridge
- Cross the bridge and take the first exit, Paseo Padre Parkway/Thornton Ave.
- Take a left over the freeway onto Paseo Padre Parkway
- Proceed on Paseo Padre Parkway to the last campus entrance on the right, before Commerce Drive

*From Oakland Airport, 80/880:*

- Follow 880 South toward San Jose
- Merge onto 84 West toward Dumbarton Bridge
- Take the Thornton Ave./Paseo Padre Parkway Exit
- Turn right onto Paseo Padre Parkway
- Proceed on Paseo Padre Parkway to the last campus entrance on the right, before Commerce Drive

*From Dublin/Pleasanton/580:*

- Follow 580 West
- Merge onto 880 South toward San Jose
- Merge onto 84 West toward Dumbarton Bridge
- Take the Thornton Ave./Paseo Padre Parkway Exit
- Turn right onto Paseo Padre Parkway
- Proceed on Paseo Padre Parkway to the last campus entrance on the right, before Commerce Drive



## Getting Here:

Where's the campus and what are my options for commuting?  
(... continued)

- **Bridge tolls**

Tolls are \$5 for westbound trips, with no toll assessed eastbound. The closest bridge to Fremont is the Dumbarton Bridge. FasTrack is available for automated toll collection via a transponder. Information is available at: <https://www.bayareafastrak.org/index.shtml>

- **Public transportation**

[511.org](http://www.511.org)

A good summary of available mass transit options and options for trip planning across transit agencies is available at: <http://transit.511.org>

Public transit is available via several options:

- o **BART**

The Daly City/Fremont and Richmond/Fremont lines serve the Union City station (approximately four miles from campus). Additional information on BART is available at: <http://www.bart.gov>

- o **ACE Rail (Altamont Corridor Express)**

ACE also provides rail service to the area. The closest stop is 4.2 miles from campus and is located at 37260 Fremont Blvd in Fremont. Connections to the Fremont campus are available via BART and/or AC Transit. Full information is available at: <https://www.acerail.com>

- o **Alameda County Transit (bus)**

The business park is also serviced by the Alameda County Transit system. The closest bus stop is near Ardenwood and Commerce Drive, which is approximately 0.5 miles from campus. More information is available at: <http://www.actransit.org>

- o **Dumbarton Express (bus)**

The Dumbarton Express provides weekday express bus service across the Dumbarton Bridge, connecting Union City (BART), Fremont, Newark, Menlo Park and Palo Alto (CalTrain). The closest stop to campus is at the Ardenwood Park and Ride Lot, which is approximately 0.8 miles from campus. [Visit http://dumbartonexpress.com/ for more information.](http://dumbartonexpress.com/)

- **Carpooling (program and incentives)**

Johnson & Johnson provides a range of commuter benefits and incentives to employees. Full details are available at: <https://www.benefitsweb.com/jnj.html>

- **Vanpools**

At this time, there are no active vanpools to this campus, but information on starting or joining a vanpool is available at: <http://www.vride.com>

- **Biking to campus**

For employees who wish to ride a bicycle to work, bicycle lockers are available in several spots on campus, which are noted on the campus map in the "Getting Around" section below. Keys to the bike lockers are available on a daily basis from the Security desk in Building 1.

As bike lockers are intended for employees to store their bikes during the business day only, bikes must be removed from the lockers and the keys returned to the Security desk on the same day the keys were checked out.





## Getting Around:

Now that I'm here, where exactly am I and how do I find things?

The Johnson & Johnson Diabetes Solutions offices are based on the 2nd Floor of Building 1 on the Fremont Campus.

- Please click [here to see the Fremont Campus Site Map](#).
- Please click [here to see 2nd Floor meeting and service rooms in Building 1](#).
- Please click [here to see 2nd Floor individual office/cubicle assignments in Building 1](#).  
*\*Note: To view office/cubicle assignments clearly, it's suggested you zoom in to 100-125%.*
- Please click [here to see 1st Floor meeting and service rooms in Building 1](#).



## Doing Business:

How do I get set up and find the support I need for my work as well as other services?

- **Identification badges: Employees, contractors and visitors**

Current employee badges will be activated to work at the new Fremont location, effective on the date of your scheduled move. No action is needed for employees.

Contractor badges must be renewed on a 90-day cycle. Sponsors of contractors will be contacted every 90 days to extend badge access.

All visitors to Fremont, including J&J employees from other locations, contractors, and temporary visitors, must be checked in via Security procedures and check in at the lobby in Building 1. Advance check-in for large groups is available by notifying Security ahead of time.

- **Keys: Offices, desks, cubicles, and file cabinets**

At Move-In:

All Milpitas employees and contractors relocating to the Fremont campus will receive instructions ahead of time to prepare them for their move and how it will happen. Each person will receive a move package that will contain, among other things, the individual's office/cubicles keys, and some may even receive keys for storage areas.





## Doing Business:

How do I get set up and find the support I need for my work as well as other services? (... continued)

During move-in dates, there will be a Concierge Team available to provide immediate assistance to ensure that employees are able to get moved in quickly and able to start their work as soon as possible. During your move-in, if you have any questions or are unable to access members of the Concierge Team, please contact Rashmi Ramaswamy at **(408) 472-8405** or [rmas24@its.jnj.com](mailto:rmas24@its.jnj.com).

After Move-In:

For questions about keys after the move is completed, please contact Security at ext. **2400**.

- **Calling Fremont Campus phone numbers**

*Please Note:*

*When directly calling a Fremont campus phone extension from the outside (i.e. off campus), the telephone area code and prefix for anyone that is part of the June 2014 move from the Milpitas to the Fremont campus is (510) **739**-XXXX. This is an important distinction, as the prefix for the extension of anyone on the Fremont campus prior to the Milpitas move is (510) **248**-XXXX.*

*On site, all Fremont phones can be reached by dialing only the four digit extension, regardless of the prefix. In addition, the main number for calling reception/the front desk from the outside is **(510) 248-2400**. To check voicemail remotely, you can call **(510) 248-2900** or **(877) 439-0811**.*

- **Directory of important services**

EMERGENCY SERVICES	
Ambulance, Fire, and Police	<b>Dial 9, then 911</b> FOR LIFE-THREATENING EMERGENCIES
Security	<b>Urgent:</b> Ext. 2499 Non Urgent: Ext. 2400 or in the J&J email system on Outlook, click on "To" and type in and send message to "Fremont Facilities Helpdesk (CNRUS)."
Medical Emergency Response Team (MERT)	The MERT team can be reached through <b>Security (ext. 2400)</b> or the <b>Campus Emergency Extension (ext. 2499)</b> .  Individual MERT members can be reached at the phone extensions listed on the Emergency Extension List posted at various places around campus.



## Doing Business:

How do I get set up and find the support I need for my work as well as other services? (... continued)

Nearest Medical Facility	Washington Clinic 2500 Mowry Ave, #212 Main: <b>(510) 608-6174</b>
<b>ADDITIONAL SERVICES</b>	
Environmental Health & Safety	Ext. <b>2447</b>
Facilities Help Desk	Ext. <b>2411</b>
IT Global Help Desk (includes computers, but not copiers, printers or fax machines.)	Ext. <b>2300</b> or <b>(855) 561-4747</b>
Live for Life fitness center	Ext. <b>2690</b>
Shipping & Receiving	Ext. <b>2661</b>
Voicemail Remote Access	<b>(510) 248-2900</b>

- **Facilities Service Requests**

To request facility-related services on the Fremont Campus (i.e. office/building repairs, gaining access, calibration, EH&S evaluations, janitorial services, room set-ups, space planning, temperature adjustments, etc.), you need to submit a Facilities Service Request, and there are three ways to do that:

- o *For routine, non-urgent requests, please submit a Facility Service Request via the Maximo system.*

The Maximo Service Request System is the preferred method for submitting routine, non-urgent Facility Service Requests. (Please note that the Maximo System is **not** for handling IT issues. For phone, telecom, computer, network access issues, please call Ext. **2300** or **(855) 561-4747**.)

To access the Maximo system, please go to <https://ecmms.jnj.com>. For instructions on how to use Maximo system, please [click here](#).



## Doing Business:

How do I get set up and find the support I need for my work as well as other services? (... continued)

- o For **urgent** Facility Service Requests or to ask a question, please call or email the Fremont Facilities Helpdesk.

From 8 a.m. to 5 p.m., Monday through Friday, a Facilities staff member at the “Live Helpdesk” will answer your call or quickly respond to your email regarding urgent Facilities Service Requests or to answer questions. Routine, non-urgent requests should be submitted via the Maximo Service Request System. (Please see links in the section just above on “routine, non-urgent requests.”)

**Facilities HelpDesk phone extension:** ext. 2411

**Facilities HelpDesk email:** In the J&J email system on Outlook, click on “To” and type in and send message to “**Fremont Facilities Helpdesk (CNRUS).**”

Examples of urgent requests would include:

- o Too hot or cold in an office or conference room
- o Water leak
- o Urgent Audio/Visual assistance needed in conference room
- o Unplanned visitor needs temporary office seating
- o No supplies in restroom
- o Short notice of an event or meeting that requires support

Examples of informational questions might include:

- o How can I reserve a bike locker?
- o What time is the last shipment for FedEx?
- o How do I use Maximo to submit a Facilities Service Request?

- **Office equipment and technical support**

- o *Phones and voicemail*

New phone numbers will be assigned to staff relocating from Milpitas to Fremont. Calls to Milpitas phone numbers will become inactive after June and will not forward, and the Milpitas voice mail system will be deactivated two weeks after the move.

Fremont uses the same voicemail system currently in use in Milpitas. Once moved, you will need to set up your new voice mail box. Please click on the following links for instructions for [initializing your new Fremont voicemail](#) and for a [reference guide to the Octel system](#).

**For remote access to the Fremont Voicemail System, please call (510) 248-2900 or (877) 439-0811**



# Doing Business:

## How do I get set up and find the support I need for my work as well as other services? (... continued)

The Fremont Move Leadership Team began communicating new phone numbers for the Fremont campus the week of May 12. Prior to your move date, it is suggested you begin informing people of your new phone number and move date. On your last day in Milpitas prior to the move, it is suggested you leave an outgoing message informing callers of your new number as messages will not be forwarded.

- o *Computers*

Computer support is provided via the Global Help Desk at **855-561-4747**.

- o *Copiers & Printers*

Copiers and printers on the Fremont campus are serviced by a vendor called Perfect Output, which reports to the Facilities department. To contact Perfect Output for service, please call **(866) 859-8593** or email [callcenter@perfectoutput.com](mailto:callcenter@perfectoutput.com).

- o *Email signatures*

Please click on the following link for [simple video instructions on how to create an email signature](#) with your new personal Fremont Campus contact information.

- **Ergonomics**

For assistance with ergonomic issues, such as adjusting office chairs or keyboard trays, please contact Anh Do at ext. **2447**.

- **Business cards (new or updating)**

To order business cards directly, you must have an ARIBA account and administrative rights to create purchase requisitions. Employees with ARIBA accounts needing new business cards can click on this [link](#) to submit their order. Employees without ARIBA accounts should contact their supervisor or administrative assistant to request new business cards.

Please note: All employees wishing to include a fax number on their new business card are encouraged to wait until after they move to Fremont before ordering new business cards. This will allow each employee to determine the most conveniently located fax/copier and include that particular machine's fax number on their business card.

- **Updating your address and contact information in JJEDS**

Following relocation to Fremont, employees should update their address and contact information in JJEDS. Please [click here](#) for step-by-step instructions on how update your personal JJEDS information.



## Doing Business:

How do I get set up and find the support I need for my work as well as other services? (... continued)

- **Office supplies**

Each department is responsible for ordering and maintaining its office supplies, which can be ordered from various vendors using Ariba. Printer and copier paper is provided in copy rooms.

- **Mail, FedEx, and shipping/receiving**

Mail stops are strategically located around the office areas and can accept outbound interoffice mail, USPS and FedEx envelopes. During the course of the day, the Shipping & Receiving staff makes rounds to pick up and drop off mail and packages.

Shipping & Receiving is located in Building 3 at the West Shipping dock, and can be reached at ext. **2661**.

Shipping & Receiving hours are 8:30 AM - 5:00 PM, Monday through Friday. The last FedEx pickup time is 3:00 PM. Packages to be sent must be dropped at Shipping & Receiving before 3pm. (If a shipment requires packing, please deliver to Shipping & Receiving by 2:00 PM.)

If you have an outgoing package and there is not a technician in the Shipping & Receiving area, please leave the package along with a completed "Shipping Request Form." Forms are available at the Shipping & Receiving service window.

The **mailing address**, which is only for U.S. Mail being sent to campus, is:

LifeScan, Inc.  
6500 Paseo Padre Parkway  
Fremont, CA 94555

The **shipping address** is for anything to be delivered to campus either directly from a vendor or by FedEx, UPS, DHL or any delivery service other than U.S. Mail:

LifeScan, Inc.  
6422 Commerce Drive  
Fremont, CA 94555



# Doing Business:

How do I get set up and find the support I need for my work as well as other services? (... continued)

- **Conference rooms**

- *Reservations*

Conference Rooms can be reserved via Outlook. Please click on the following link for [simple video instructions on how to book a conference room](#) on the Fremont campus using Outlook.

- *Capacities, Equipment and Capabilities*

There are 18 different conference rooms in Building 1 that can be reserved for meetings, with 8 on the 1st floor and 10 on the 2nd floor. To see a list that includes the name, room number, capacity, and A/V accommodations for each Building 1 conference room, [please click here](#). To see where each conference room is located, please click on the following links to the [1st floor](#) and [2nd floor](#).

- **Catering for meetings**

Chipotle, Panera, Pizza Italia, Specialties, and many other restaurants nearby are available for catering. There are also catering services available, such as [www.JustCatering.net](http://www.JustCatering.net) and [www.CateringByTOW.com](http://www.CateringByTOW.com).

- **Events and All-Hands Meetings**

Individuals or departments planning to hold any type of event on campus should initiate a request through the Facilities Service Request System. Please click on the following link for information on [Facilities Service Requests](#).

- **Visitor accommodations/hotels**

The following Johnson & Johnson preferred hotels are located near the campus:

Courtyard Newark  
34905 Newark Blvd.  
Newark, CA  
(510) 792-5200  
1.1 miles from campus

Residence Inn Newark  
35466 Dumbarton Ct.  
Newark, CA  
(510) 739-6000  
1.5 miles from campus

Aloft Hotel  
8200 Gateway Blvd.  
Newark, CA  
(510) 494-8800  
1.7 miles from campus



# Eating Here and There:

Where can I get a cup of coffee, a meal, or a snack?

- **Break rooms, onsite coffee bars, vending machines**

Coffee Bars are located throughout campus and feature complementary coffee, tea and purified water, refrigerators, microwaves, toaster ovens, and vending machines. To see where coffee bars are located in Building 1, please click on the following links for the [1st floor](#) and [2nd floor](#).

- **Nearby restaurants**

The Fremont campus is located near a number of restaurants, offering both take-out and dine-in options. Below is just a sample of the options near the campus:

Chat Patta Corner  
(Vegetarian, Indian Cuisine)  
34751 Ardenwood Blvd.  
Fremont, CA  
.9 miles from campus

Darda Fremont Restaurant  
(Chinese, Seafood)  
34755 Ardenwood Blvd.  
Fremont, CA  
.9 miles from campus

+Plus at the Aloft Silicon Valley Hotel  
8200 Gateway Blvd.  
Newark, CA  
1.7 miles from campus

Taqueria Los Gallos (Mexican, Tex-Mex)  
35232 Newark Blvd.  
Newark, CA  
1.6 miles from campus

Surobi Afghan Palace (Afghan)  
34765 Ardenwood Blvd.  
Fremont, CA  
1 mile from campus

TOGO's (Sandwiches)  
35214 Newark Blvd.  
Newark, CA  
1.6 miles from campus

Pizza Italia (Pizza, Italian)  
34765 Ardenwood Blvd.  
Fremont, CA  
1 mile from campus

Fullbloom Baking Company (Bakery)  
6500 Overlake Pl.  
Newark, CA  
1.9 miles from campus

- **Coffee or tea (off campus)**

Emocha Café (Coffee and Tea)  
6600 Dumbarton Cir.  
Fremont, CA  
.9 miles from campus

Bubbles (Bubble tea, coffee and tea)  
35201 Newark Blvd  
Newark, CA 94560  
1.2 miles from campus

Starbucks  
5877 Jarvis Ave  
Newark, CA 94560  
0.9 miles from campus

Pete's Coffee and Tea  
2780 Mowry Ave  
Fremont, CA 94538  
4.6 miles from campus

Starbucks  
35040 Newark Blvd  
Newark, CA 94560  
1 mile from campus

- **On-campus eating areas**

There are several eating areas around campus, including a large indoor area on the [first floor of Building 1](#) and numerous areas outside in the Quad and around campus.





# Keeping Fit:

What's available to help me stay on top of my exercise routine?

- **Fitness center**

**Note: The Fremont Live for Life fitness center will be closed from Monday, June 23rd through Sunday, July 6th and will re-open at 5:00 a.m. on Monday, July 7th.**

The Live for Life fitness center on the Fremont campus is located in Building 3 and can be reached at ext. **2690**. To find Building 3, please see the [Site Map](#) for the Fremont campus in the "Getting Around" section of this guide.

Equipment in Live for Life includes treadmills, ellipticals, recumbent stationary bikes, upright stationary bikes, stairmasters, and a variety of weight training equipment and other fitness machines.

To join Live for Life in Fremont, please visit the Live for Life website ([www.MyLiveForLife.com](http://www.MyLiveForLife.com)), complete a health evaluation/PAR-Q, then contact the Wellness Professional, Maria Dela Rosa at ext. **2691**.

Live for Life is open from 5 a.m. to 9 p.m., Monday through Friday. It is staffed on Tuesday and Wednesday from 9 a.m. to 2 p.m. and again from 4 p.m. to 7 p.m.

- **Other on- or near-campus sports and fitness options**

- *Volleyball courts*

(Please see the Fremont Campus [Site Map](#) in the "Getting Around" section of this guide.)

- *Parcourse*

(Please see the Fremont Campus [Site Map](#) in the "Getting Around" section of this guide.)

- *Walking, running and nature trails*

The campus is in close proximity to a number of hiking and exercise trails, including:

- Coyote Hills Regional Park, which is comprised of nearly 978 acres of marshland and rolling grassland covered hills. Visitor activities include bicycling, walking/hiking, bird-watching, jogging, nature exploration, a museum and picnicking. Coyote Hills Regional Park is located at 8000 Patterson Ranch Rd. in Fremont.
- Ardenwood Historic Farm, which is a working farm dating back to the 1850s. The farm offers a fruit stand and picnic areas, as well as a parcourse and walking trail directly adjacent to the Fremont Campus. Ardenwood Historic Farm is located in Fremont at 34600 Ardenwood Blvd.

- **Showers and lockers**

### **Building 1**

Showers are available in B1 in the east restrooms on the first floor. There is one shower per gender in each restroom at this location. Please bring your own towel. As lockers do not exist at this location, you should plan accordingly.

### **Building 3**

Showers are available in B3 and are located in the restroom core within the Fitness Center. Lockers are available at this location. Please bring your own towel and lock. Due to a limited number of lockers, please plan to remove locker contents daily



## Managing Life:

What's available in the surrounding neighborhood to help me handle my personal business?

- **Shopping centers/malls nearby**

The Fremont campus is home to several nearby malls and shopping centers, including:

Lido Faire Shopping  
35219 Newark Blvd.  
Newark, CA  
1.3 miles from campus

Union Landing  
Union Landing Blvd.  
Union City, CA  
4.2 miles from campus

Newark Market Place  
5885 Jarvis Ave.  
Newark, CA  
1.3 miles from campus

NewPark Mall  
2086 Newpark Mall Rd.  
Newark, CA  
6.1 miles from campus

NewPark Plaza  
5492 Newpark Mall Rd.  
Newark, CA  
3.1 miles from campus

- **Gas stations nearby**

Jarvis Shell  
6005 Jarvis Ave.  
Newark, CA 94560  
1.2 miles from campus

76  
31901 Alvarado Blvd.  
Union City, CA 94587  
3.1 miles from campus

Chevron  
5502 Thornton Ave.  
Newark, CA 94560  
3 miles from campus

Valero  
37635 Blacow Rd.  
Fremont, CA 94536  
4.3 miles from campus

# J&J West Coast Campus Guide

Fremont CA - CWCC

Site Map

## LEGEND

**DP** = DISABLED ACCESS PARKING

**VP** = VISITOR PARKING

**P** = PATIO

**Q** = QUAD/AMPHITHEATER

**B** = BIKE LOCKERS

**V** = VOLLEYBALL

**PC** = PAR COURSE

**SD** = SITE DRIVEWAY

**EA** = EVACUATION AREA



 = SUGGESTED PARKING AREAS FOR B1 AND B3

# J&J West Coast Campus Guide

## Fremont CA - CWCC

### 2nd Floor

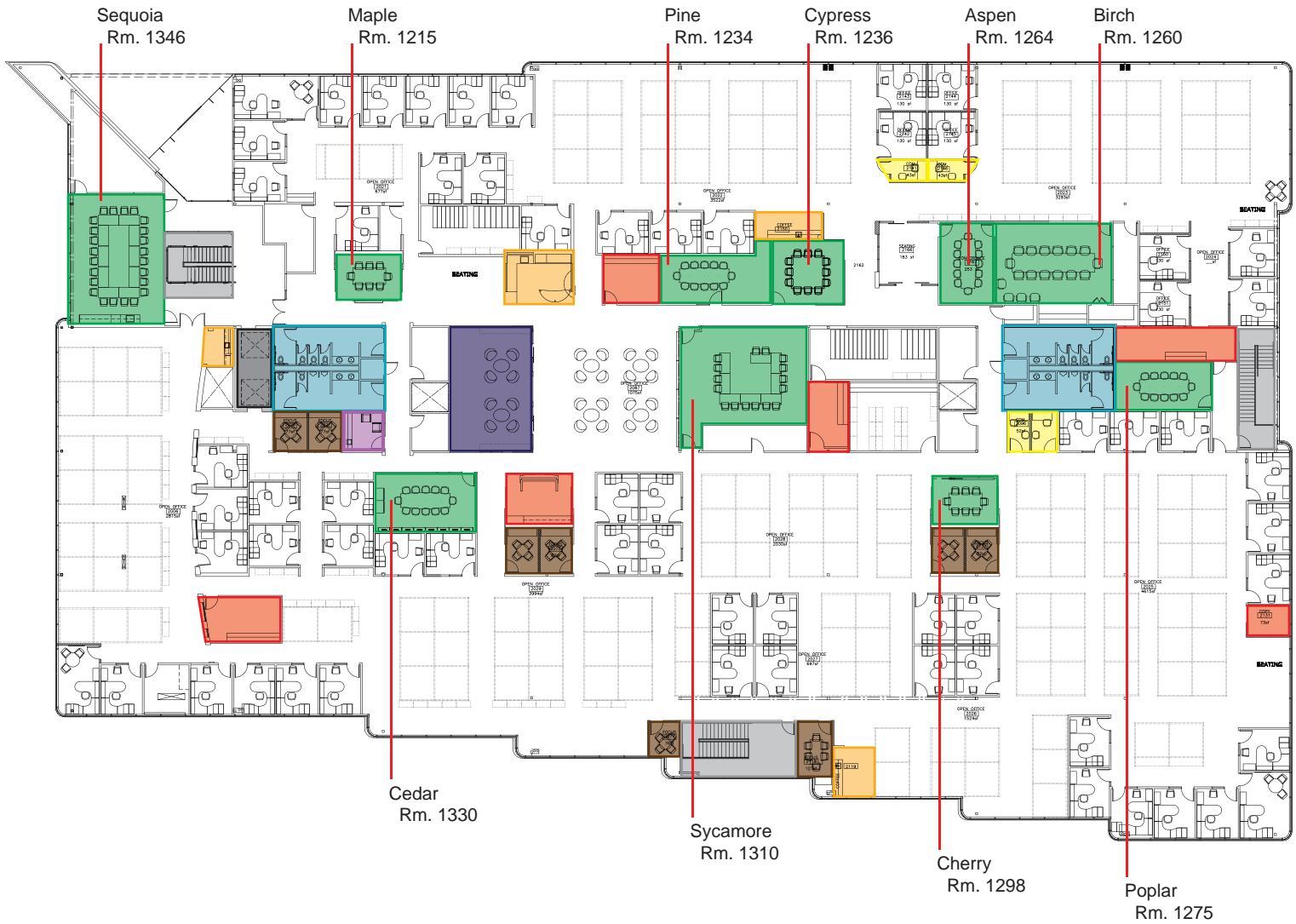

- |  |   |
|--|---|
| <span style="display: inline-block; width: 20px; height: 10px; background-color: #2e8b57; border: 1px solid black;"></span> CONFERENCE, MEETING AND TRAINING ROOMS | <span style="display: inline-block; width: 20px; height: 10px; background-color: #ffff00; border: 1px solid black;"></span> COMMUNICATION ROOMS |
| <span style="display: inline-block; width: 20px; height: 10px; background-color: #4682b4; border: 1px solid black;"></span> RESTROOMS AND/OR SHOWERS               | <span style="display: inline-block; width: 20px; height: 10px; background-color: #483d8b; border: 1px solid black;"></span> WORK LOUNGE         |
| <span style="display: inline-block; width: 20px; height: 10px; background-color: #ff4500; border: 1px solid black;"></span> COPY ROOMS                             | <span style="display: inline-block; width: 20px; height: 10px; background-color: #dda0dd; border: 1px solid black;"></span> NURTURE ROOM        |
| <span style="display: inline-block; width: 20px; height: 10px; background-color: #ff8c00; border: 1px solid black;"></span> BREAK AREAS/COFFEE BARS                | <span style="display: inline-block; width: 20px; height: 10px; background-color: #a9a9a9; border: 1px solid black;"></span> STAIRWAYS           |
| <span style="display: inline-block; width: 20px; height: 10px; background-color: #8b4513; border: 1px solid black;"></span> FOCUS ROOMS                            | <span style="display: inline-block; width: 20px; height: 10px; background-color: #333333; border: 1px solid black;"></span> ELEVATORS           |

# J&J West Coast Campus Guide

## Fremont CA - CWCC

### 1st Floor

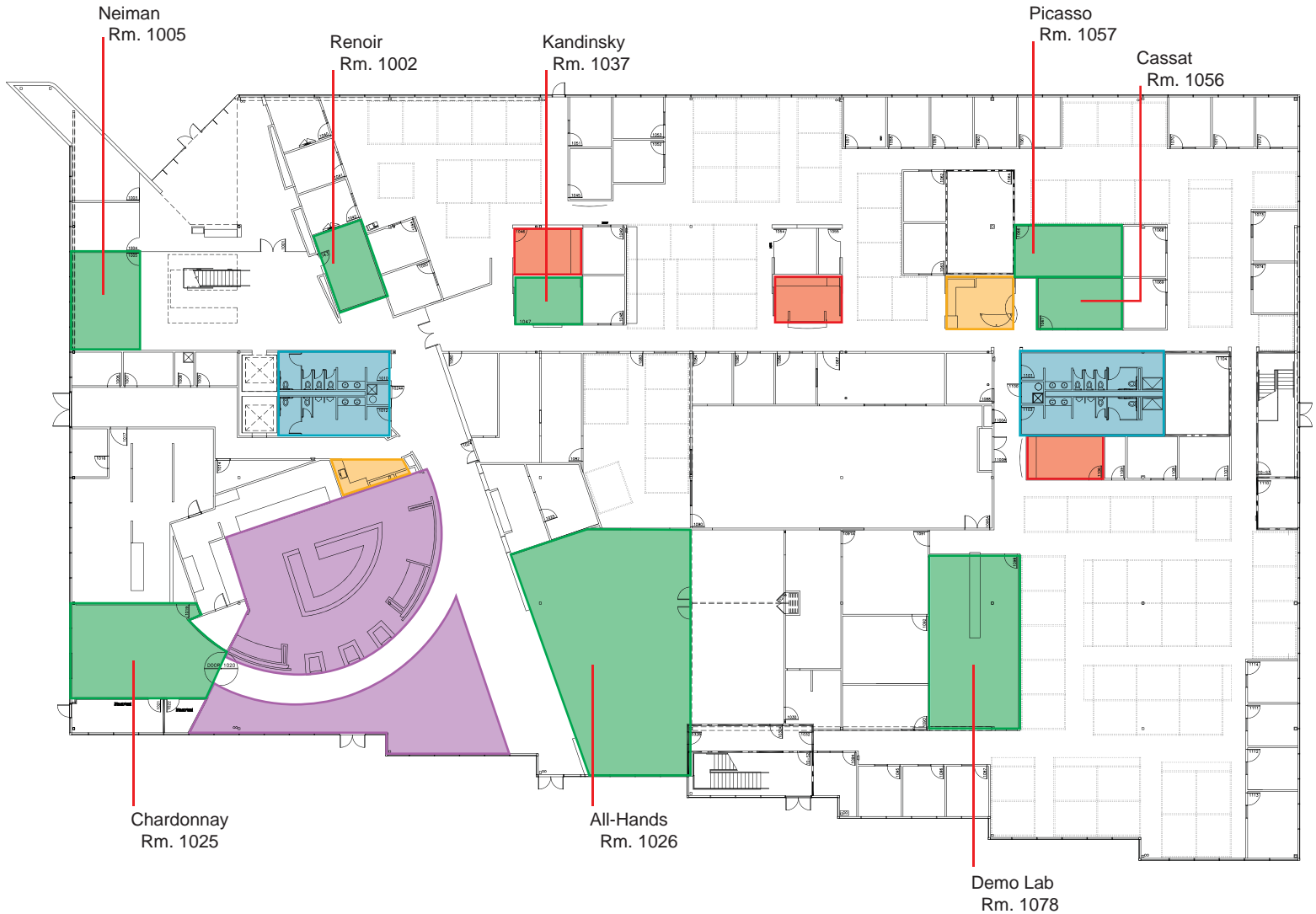

- CONFERENCE, MEETING AND TRAINING ROOMS
- RESTROOMS AND/OR SHOWERS
- COPY ROOMS
- BREAK AREAS/COFFEE BARS
- LUNCH SEATING AREA